

# Soils Map

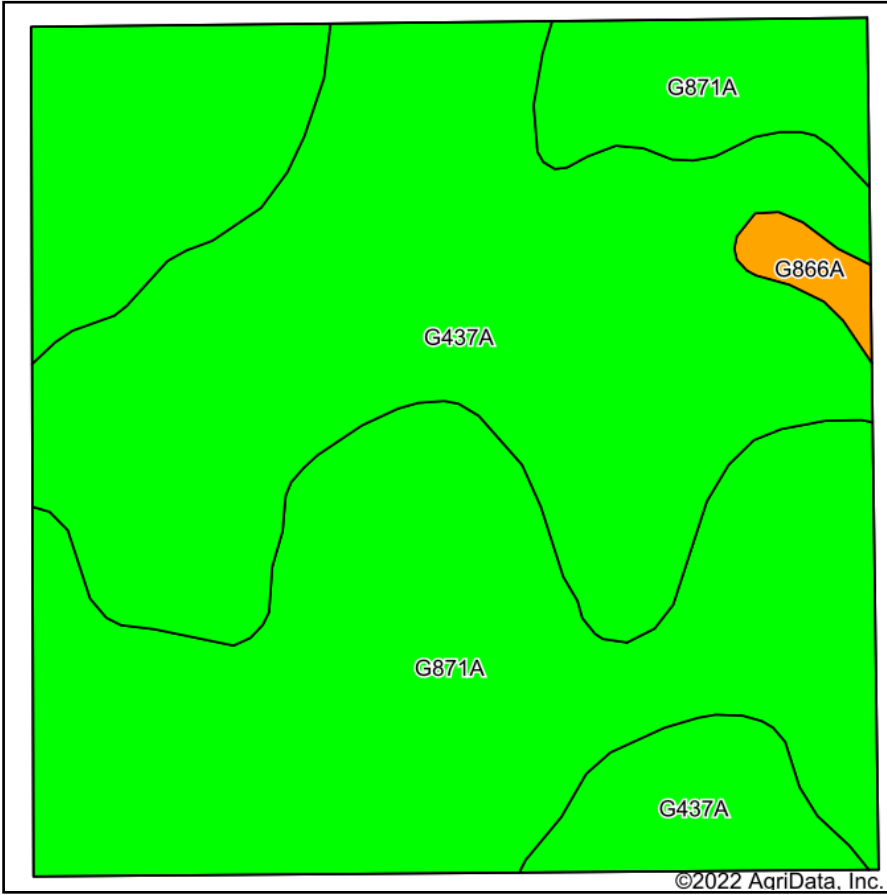

Soils data provided by USDA and NRCS.

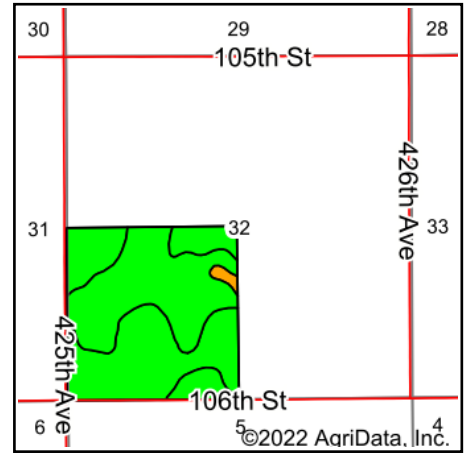



State: **South Dakota**  
 County: **Marshall**  
 Location: **32-128N-57W**  
 Township: **White**  
 Acres: **160.4**  
 Date: **4/4/2022**

*Vold Auctioneers & Realty*

Maps Provided By:  
  
 CUSTOMIZED ONLINE MAPPING  
 © AgriData, Inc. 2021 www.AgriDataInc.com



Area Symbol: SD091, Soil Area Version: 22

Code	Soil Description	Acres	Percent of field	PI Legend	Non-Irr Class *c	Range Production (lbs/acre/yr)	Productivity Index	Corn Bu	*n NCCPI Soybeans
G871A	Beotia silt loam, 0 to 2 percent slopes	84.20	52.5%		IIc	2885	98	6	63
G437A	Beotia-Bearden silt loams, 0 to 2 percent slopes	74.17	46.2%		IIc	3297	92	7	59
G866A	Harmony-Aberdeen silty clay loams, 0 to 2 percent slopes	2.03	1.3%		IIs	2591	80	43	53
<b>Weighted Average</b>					<b>2.00</b>	<b>3071.8</b>	<b>95</b>	<b>6.9</b>	<b>*n 61</b>

\*n: The aggregation method is "Weighted Average using all components"

\*c: Using Capabilities Class Dominant Condition Aggregation Method

Soils data provided by USDA and NRCS.