

Soils Map

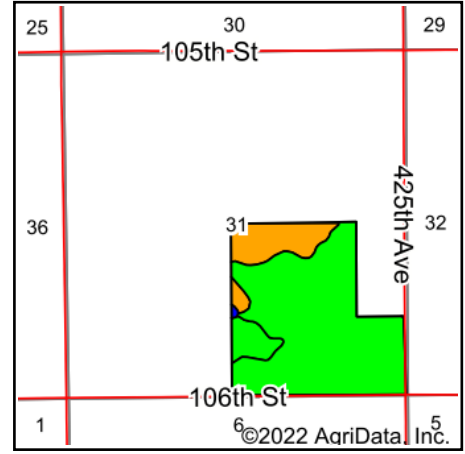

State: **South Dakota**
 County: **Marshall**
 Location: **31-128N-57W**
 Township: **White**
 Acres: **136.55**
 Date: **4/4/2022**

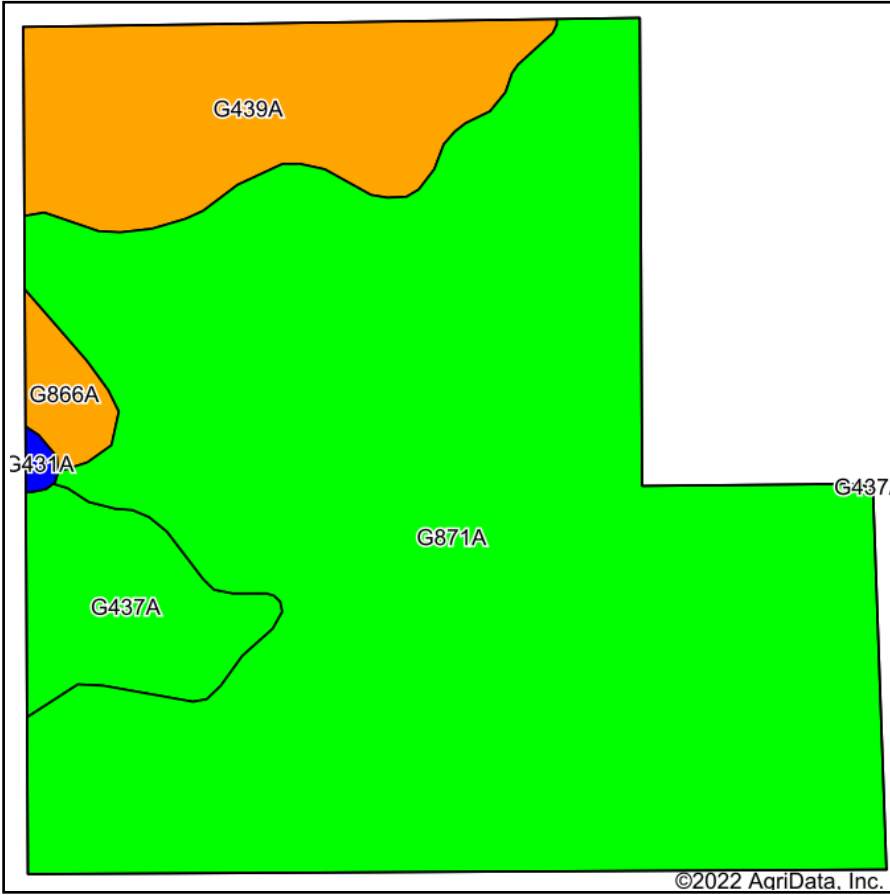



Vold Auctioneers & Realty

Maps Provided By:

 CUSTOMIZED ONLINE MAPPING
 © AgriData, Inc. 2021 www.AgriDataInc.com



Area Symbol: SD091, Soil Area Version: 22

Code	Soil Description	Acres	Percent of field	PI Legend	Non-Irr Class *c	Range Production (lbs/acre/yr)	Productivity Index	Corn Bu	*n NCCPI Soybeans
G871A	Beotia silt loam, 0 to 2 percent slopes	107.58	78.8%		llc	2885	98	6	63
G439A	Bearden-Tonka, silty substratum silt loams, 0 to 2 percent slopes	18.12	13.3%		lle	4004	73	5	49
G437A	Beotia-Bearden silt loams, 0 to 2 percent slopes	8.30	6.1%		llc	3297	92	7	59
G866A	Harmony-Aberdeen silty clay loams, 0 to 2 percent slopes	2.21	1.6%		lls	2591	80	43	53
G431A	Bearden silt loam, 0 to 2 percent slopes	0.34	0.2%		lle	3996	81		56
Weighted Average					2.00	3056.5	94	6.5	*n 60.7

*n: The aggregation method is "Weighted Average using all components"

*c: Using Capabilities Class Dominant Condition Aggregation Method

Soils data provided by USDA and NRCS.